

Dairy Fittings



Dairy Fittings

Hygienic Tubes

DIN Metric Tubes

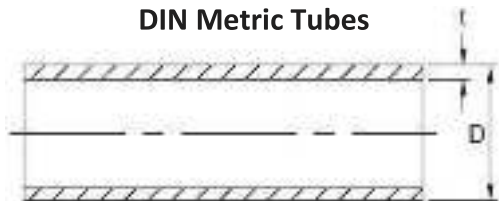

Material: AISI 304/316
6M Lengths
Long Weld Bead Rolled/Seamless
Polished O/D

DM	Kg/m	D/mm	t/mm
10	0.43	13	1.5
15	0.66	18	1.5
20	0.81	22	1.5
25	1.03	28	1.5
32	1.26	34	1.5
40	1.50	40	1.5
50	1.90	52	1.5
65	3.43	70	2.0
80	4.16	85	2.0
100	5.03	104	2.0
125	6.36	129	2.0
150	7.49	154	2.0
200	10.12	204	2.0

ISO STD O/D Tubes



Material: AISI 304/316
6M Lengths
Long Weld Bead Rolled/Seamless
Polished O/D

DM	Kg/m	D/mm	t/mm
1	0.898	25.4	1.50
1 ½	1.375	38.1	1.50
2	1.852	50.8	1.50
2 ½	2.329	63.5	1.50
3	2.985	76.1	1.50
4	4.016	101.6	1.50

Pipe Clamp with Shank

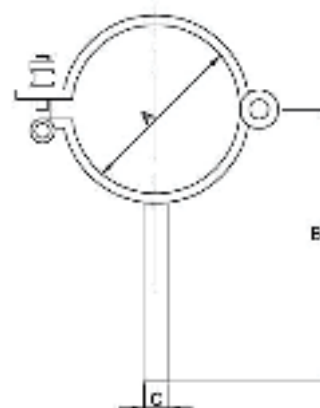

DN	A(mm)	B(mm)	C(mm)
25	28	74	8
32	34	77	8
40	40	80	8
50	52	86	8
65	70	95	12
80	85	103	12
100	104	112	12
125	129	125	12
150	154	137	12

Dairy Fittings

Hygienic Bends

Hygienic Bends - 90° Bends DIN Metric

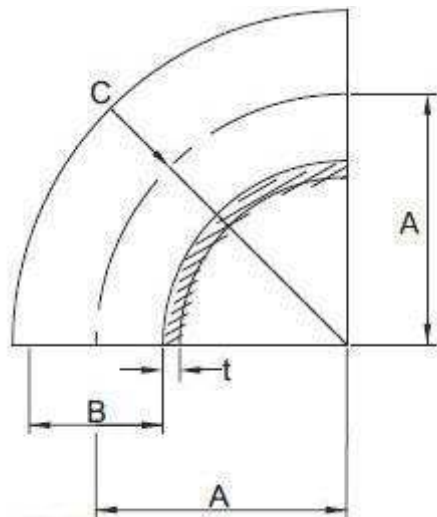

DIN Metric

DN	A(mm)	B(mm)	C(mm)	t(mm)
10	26.0	10	26.0	1.5
15	35.0	16	35.0	1.5
20	40.0	20	40.0	1.5
25	50.0	26	50.0	1.5
32	55.0	32	55.0	1.5
40	60.0	38	60.0	1.5
50	70.0	50	70.0	1.5
65	80.0	66	80.0	2.0
80	90.0	81	90.0	2.0
100	100	100	100.0	2.0
125	187.5	125	187.5	2.0
150	225.0	150	225.0	2.0
200	300.0	200	300.0	2.0

Hygienic Bends - 90° Bends ISO STD

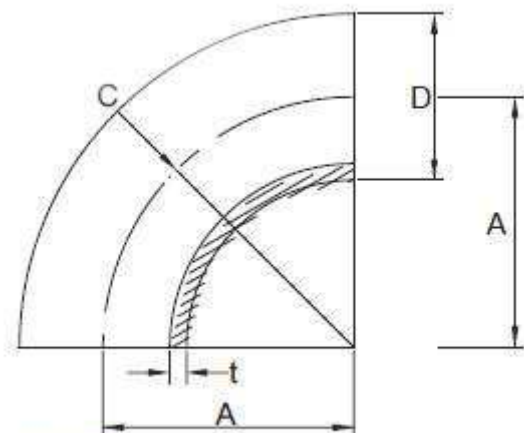

ISO STD

DN Inch	A(mm)	B(mm)	C(mm)	t(mm)
1	38.1	38.1	25.4	1.5
1 1/2	57.2	57.2	38.1	1.5
2	76.2	76.2	50.8	1.5
2 1/2	95.3	95.3	63.5	1.5
3	114.3	114.3	76.2	2.0
4	152.4	152.4	101.6	2.0

Hygienic Bends - 90° Long Bend DIN Metric

Size	D (mm)	L1 (mm)	R (mm)	t (mm)
25	28	65	50	1.5
32	34	73	55	1.5
40	40	80	60	1.5
50	52	92	70	1.5
65	70	105	80	2.0
80	85	119	90	2.0
100	104	140	100	2.0

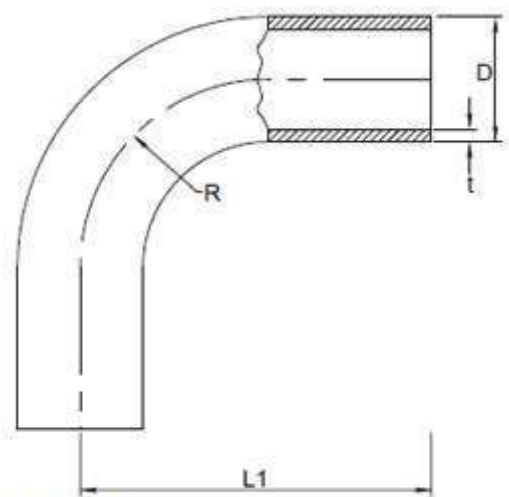

DIN Metric

Dairy Fittings

Hygienic Bends - 90° Long Bend ISO STD

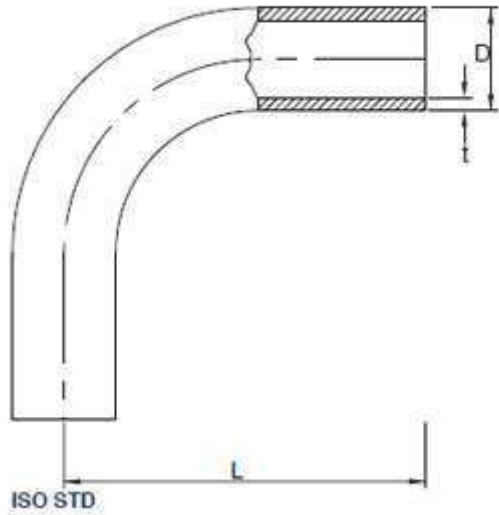

Material: 304/316

Size Inch	D (mm)	L (mm)	t (mm)
1	25.4	65	1.65
1 1/2	38.1	85	1.65
2	50.8	110	1.65
2 1/2	63.5	135	1.65
3	76.2	155	1.65
4	101.6	195	2.10

Hygienic Tees DIN STD Long

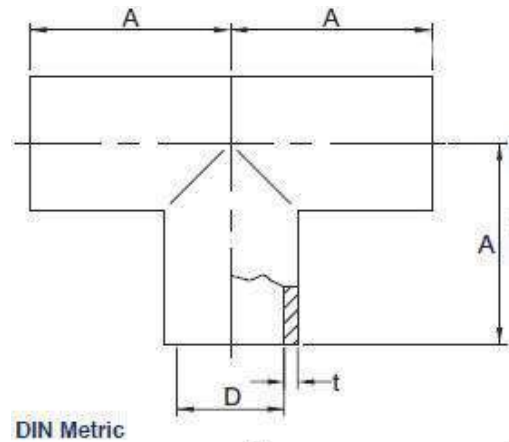

Material: 304/316

DN	A (mm)	D (mm)	t (mm)
10	35.0	10	1.5
15	35.0	16	1.5
20	40.0	20	1.5
25	50.0	26	1.5
32	55.0	32	1.5
40	60.0	38	1.5
50	70.0	50	1.5
65	80.0	66	2.0
80	90.0	81	2.0
100	100.0	100	2.0
125	187.5	125	2.0
150	225.0	150	2.0
200	300.0	200	2.0

Hygienic Tees ISO STD Long

Material: 304/316

DN Inch	A (mm)	D (mm)	t (mm)
1	44	25.4	1.5
1 1/2	64	38.1	1.5
2	89	50.8	1.5
2 1/2	114	63.5	2.0
3	134	76.2	2.0
4	174	101.6	2.0

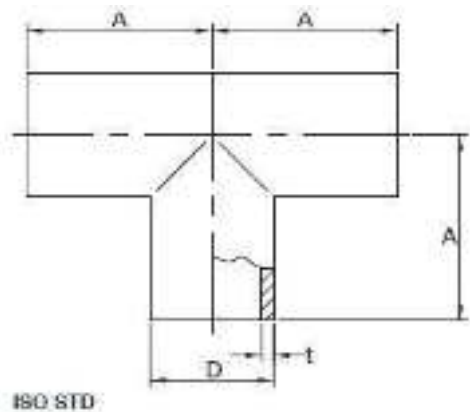

Dairy Fittings

Hygienic Tees DIN STD Short

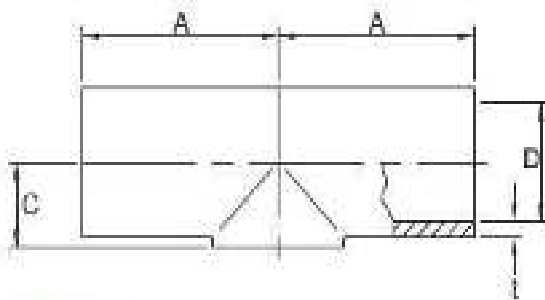

DIN Metric

DN	A (mm)	D (mm)	C (mm)	t (mm)
10	35.0	10	-	1.5
15	35.0	16	11.0	1.5
20	40.0	20	13.0	1.5
25	50.0	26	16.0	1.5
32	55.0	32	19.5	1.5
40	60.0	38	23.0	1.5
50	70.0	50	30.0	1.5
65	80.0	66	40.0	2.0
80	90.0	81	47.5	2.0
100	100.0	100	58.0	2.0
125	187.5	125	74.0	2.0
150	225.0	150	90.0	2.0
200	300.0	200	115.0	2.0

Hygienic Tees ISO STD Short

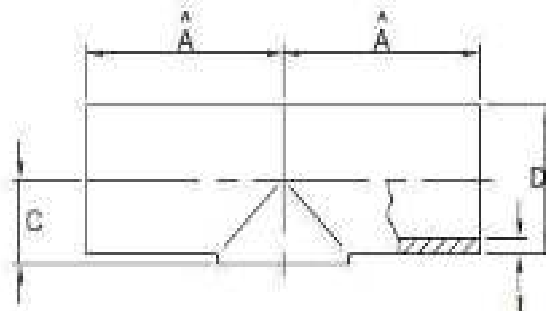

ISO STD

DN Inch	A (mm)	D (mm)	C (mm)	t (mm)
1	44	25.4	14	1.5
1 1/2	64	38.1	22	1.5
2	89	50.8	29	1.5
2 1/2	114	63.5	35	2.0
3	134	76.2	41	2.0
4	174	101.6	55	2.0

DN	D1 (mm)	D2 (mm)	C (mm)	t (mm)
15/10	16	10	11.2	1.5
20/10	20	10	18.7	1.5
20/15	20	16	7.5	1.5
25/15	26	16	18.7	1.5
25/20	26	20	11.2	1.5
40/20	38	20	33.5	1.5
40/25	38	26	22.5	1.5
40/32	38	32	11.2	1.5
50/25	50	26	44.8	1.5
50/40	50	38	22.5	1.5
65/25	66	26	75.0	2.0
65/40	66	38	52.5	2.0
65/50	66	50	30.0	2.0
80/50	81	50	58.0	2.0
80/65	81	66	28.0	2.0
100/50	100	50	93.0	2.0
100/65	100	66	63.5	2.0
100/80	100	81	35.5	2.0
125/80	125	81	82.0	2.0
125/100	125	100	46.7	2.0
150/100	150	100	92.0	2.0
150/125	150	125	45.5	2.0

Concentric Reducers - DIN Metric STD

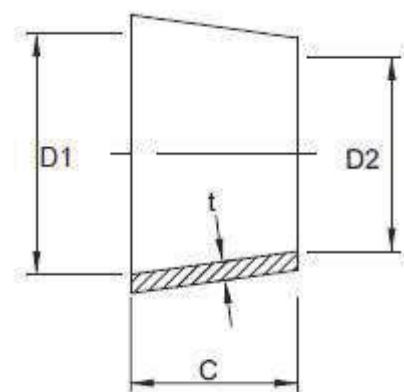

DIN Metric

Dairy Fittings

Concentric Reducers - ISO STD

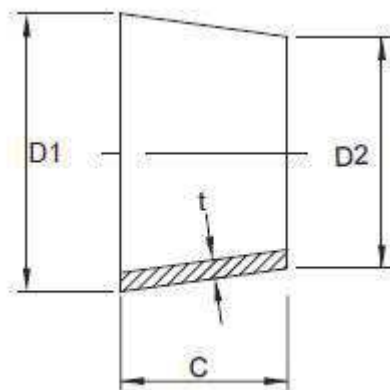

ISO STD

Material: 304/316

DN Inch	D ₁ (mm)	D ₂ (mm)	C (mm)	t (mm)
1 ¹ / ₂ /1	38.1	25.4	22.8	1.5
2/1	50.8	25.4	46.5	1.5
2/1 ¹ / ₂	50.8	38.1	23.7	1.5
2 ¹ / ₂ /1 ¹ / ₂	63.5	38.1	47.4	1.5
2 ¹ / ₂ /2	63.5	50.8	23.7	1.5
3/2	76.1	50.8	47.2	1.5
3/2 ¹ / ₂	76.1	63.5	23.5	2.0
4/2	101.6	50.8	92.9	2.0
4/2 ¹ / ₂	101.6	63.5	69.2	2.0
4/3	101.6	76.1	45.7	2.0

Eccentric Reducers DIN Metric STD

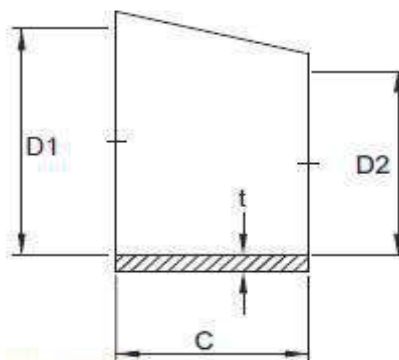

DIN Metric

Material: 304/316

DN	D ₁ (mm)	D ₂ (mm)	C (mm)	t (mm)
15/10	16	10	16.5	1.5
20/15	20	16	11.0	1.5
25/15	26	16	27.5	1.5
25/20	26	20	16.5	1.5
40/25	38	26	33.0	1.5
50/25	50	26	68.0	1.5
50/40	50	38	33.0	1.5
65/40	66	50	44.0	2.0
65/50	81	50	85.2	2.0
80/50	81	66	41.2	2.0
80/65	100	50	137.4	2.0
100/65	104	70	93.0	2.0
100/80	104	85	53.0	2.0
125/80	129	85	120.0	2.0
125/100	129	104	69.0	2.0
150/100	154	104	138.0	2.0
150/125	154	129	69.0	2.0

Eccentric Reducers ISO STD

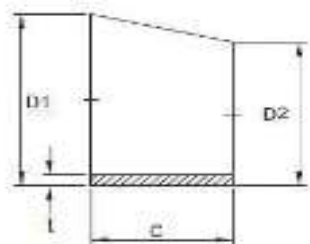

ISO STD

DN Inch	D ₁ (mm)	D ₂ (mm)	C (mm)	t (mm)
1 ¹ / ₂ /1	38.1	25.4	37.0	1.5
2/1	50.8	25.4	73.0	1.5
2/1 ¹ / ₂	50.8	38.1	37.0	1.5
2 ¹ / ₂ /1 ¹ / ₂	63.5	38.1	73.0	2.0
2 ¹ / ₂ /2	63.5	50.8	37.0	2.0
3/2	76.1	50.8	73.0	2.0
3/2 ¹ / ₂	76.1	63.5	37.0	2.0
4/2 ¹ / ₂	101.6	63.5	110.0	2.0
4/3	101.6	76.1	74.0	2.0

Dairy Fittings

Hygienic Unions Weld/Weld

These unions are manufactured from stainless steel (AISI 304) and consist of liner, male part, nut and gasket. The liner and male parts are suitable for expanding to thin-walled stainless steel pipes. The gasket which is located in a groove in the male part, is made from acid and grease resistant synthetic Nitrite rubber. Complete unions are supplied with rubber gaskets. Max. temp. 130° C.

Hygienic Unions Weld/Weld - DIN Type

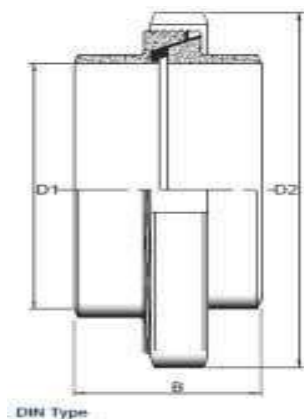

Nominal Diameter (mm)	D1 (mm)	D2 (mm)	B (mm)
10	10	38	34
15	15	44	34
20	20	54	36
25	26	63	45
32	32	70	51
40	38	78	53
50	50	92	57
65	66	112	65
80	81	127	75
100	100	148	89
125	125	178	70
150	150	210	76

Hygienic Unions Weld/Weld - SMS Type

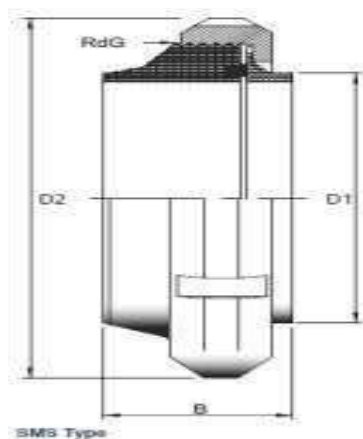

Nominal Diameter (mm)	D1 (mm)	D2 (mm)	B (mm)
25	25.4	51	23.5
38	38.1	74	30
51	50.8	84	30
63.5	63.5	100	34
76	76.2	114	35
101.6	101.6	154	48

Dairy Fittings

Hygienic Unions Weld/Weld - ISO STD DS Type

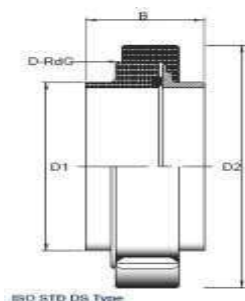

Nominal Diameter (mm)	D1 (mm)	D2 (mm)	B (mm)
1	25.4	57	36
1 1/2	38.1	71	38
2	51	86	40
2 1/2	63.5	103	46
3	76.2	115	48
4	101.6	147	48

Butterfly Valve-Weld End - ISO STD

Inch	E (mm)	H ₁ (mm)	K (mm)
1	39.5	46.0	122
1 1/2	42.5	47.0	122
2	52.5	52.0	122
2 1/2	56.0	54.0	162
3	62.5	62.0	162
4	79.0	76.0	162

Butterfly Valve-Weld End DIN STD

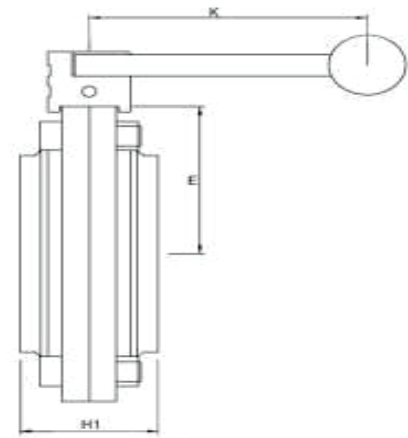

DIN	E (mm)	H ₁ (mm)	K (mm)
25	32.5	47.0	122
32	32.5	47.0	122
40	32.5	47.0	122
50	42.0	52.0	122
65	53.5	58.0	162
80	64.0	64.0	162
100	77.0	80.0	162
125	99.0	80.0	162
150	111.5	80.0	162